



CFX

CARTON FORMER

**GLUE
and
LOCK
STYLE**



MODELS:
CFG/CFL-100
CFG/CFL-130/230
CFG/CFL-150/250

Model **CFG-250**

FEATURES & BENEFITS:

- Compact design **requires less floor space.**
- Cam controlled functions **insures smooth, quiet, continuous 24/7 applications.**
- Ergonomically correct carton magazine **allows loading from either side of the machine.**
- Oscillating magazine rods **improve uptime results.**
- Angled feed and forming design allows **easy access and improved vision lines.**
- Low force roller forming cavity **provides extra compression for glue applications and is gentler on the carton/trays.**
- Shorter stroke and lower velocity forming motion **make depth of scoring and consistency less critical.**
- Quick change forming head tooling **reduces changeover time.**
- Multiple carton discharge options **provides application flexibility.**
- Built in accordance with ANSI/PMMI B155.1 safety standards, cGMP, and CE friendly design. Guarding package executed for easy access and to enhance vision lines throughout the entire machine.

SPECIFICATIONS

SPECIFICATIONS

CFX

CARTON FORMER

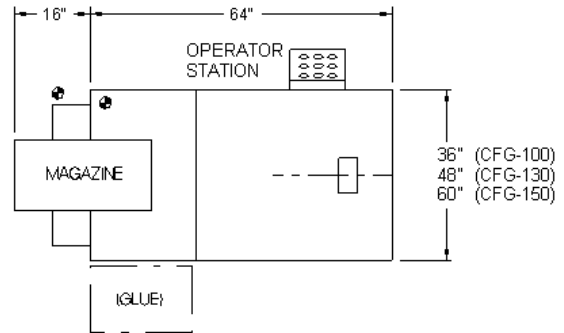
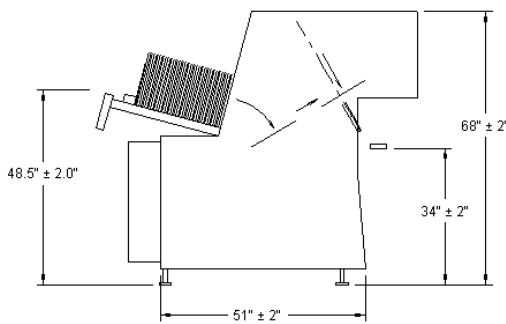

BASE MACHINE:

- Magazine 30" inclined with oscillating rods
- Carton Setup Reciprocating vacuum arm style, cam driven
- Carton Conveyor Flighted shuttle arm, cam driven
- Carton Closing Hot melt adhesive or lock (end or corner) style
- Control System Allen-Bradley MicroLogix PLC
- Operator Interface Standard pushbutton panel
- Main Drive AC fixed motor with variable speed pulley and clutch/brake control
- Guarding Lexan upper guards and painted sheet metal lower guards
- Frame Welded and bolted bar stock, painted (Steel-It)
- Power 230/460 VAC, 3 Phase (with disconnect), 60 Hz
- Air Less than 3.0 CFM @ 80 PSI, depending on application

OPTIONAL FEATURES:

- Detent Overload Clutch
- Message Display
- Touchscreen HMI
- Swing Arm Control Panel
- 42" Long Magazine
- Discharge Conveyors
- Cluster Lubrication
- Special paint
- Casters
- Spare Parts Kit

CARTON STYLES:

- Four Corner Tray
- Single Top Flap
- Tri-Seal Carton
- Combination Flap Closures
- Hood Top Carton
- Simplex Carton and Tray
- Paperboard and Corrugate

CARTONS	L	W		D	BW	BL**		SPEEDS*
Minimum*	3 in	2.50 in		1.00 in	6 in	4 in		
Maximum* Single Head		Glue	Lock			Glue	Lock	Up to 70 CPM
100	16.50"	17"	19"	4 in	22 in	18.50"	20.50"	
130	28.50"	17"	19"	4 in	34 in	18.50"	20.50"	
150	40.50"	17"	19"	4 in	46 in	18.50"	20.50"	
Maximum* Dual Head		Glue	Lock			Glue	Lock	Up to 140 CPM
230	10.00"	17"	19"	4 in	14 in	18.50"	20.50"	
250	16.00"	17"	19"	4 in	20 in	18.50"	20.50"	

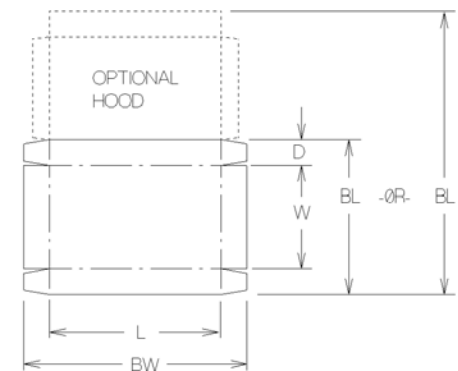

* The exact carton range and speed will vary with each application. Consult factory for other size ranges.

**This dimension applies with or without a cover.



763.425.8808

www.mgsmachine.com

Putting Our Best on the Line

1/2009